

# Data Sheet

## Waterproofing

Structural Waterproofing from Rawell

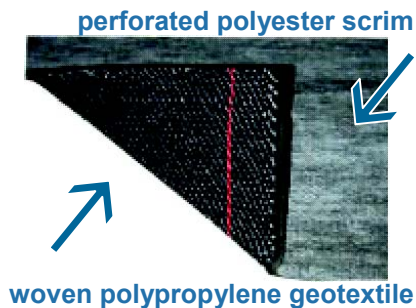

### RAWMAT<sup>®</sup> HDB Type S2 Structural (2m x 30m)

A factory prehydrated sodium bentonite membrane for the waterproofing of below ground structures in accordance with BS8102 : 1990 where an oversite blinding has been specified.

#### INSTALLATION

All projects must be assessed on an individual basis as installation details may differ from project to project. For project specific recommendations and CAD details contact the Technical Sales Department at Rawell.

The surface onto which the RAWMAT<sup>®</sup> HDB Type S2 is to be laid shall be smooth concrete, free of abrupt irregularities with all lumps removed and voids filled with mortar or RAWPASTE Mastic. Air hose the surface to clean laitance and dirt to allow a bond to form between the bentonite and the structure. Installation may continue during light rainfall providing the blinding process continues until all of the RAWMAT<sup>®</sup> HDB Type S2 is covered with the correct depth of protective layer.

The RAWMAT<sup>®</sup> HDB Type S2 shall be laid with the non-woven scrim in contact with the blinded concrete and the woven geotextile uppermost. Sealed laps will be achieved simply by overlapping the adjacent sheet to a minimum of 100mm. The RAWMAT<sup>®</sup> HDB Type S2 is for use across large floor slabs or roof structures, it can be used vertically but care should be taken and due to the weight of the rolls, use of a certified Rawell lifting device is highly recommended to ensure efficient handling. When placed under a slab, the RAWMAT<sup>®</sup> HDB Type S2 shall protrude beyond the building line by at least 150mm. This provides contact with the vertical membrane ensuring continuity of the waterproofing system.

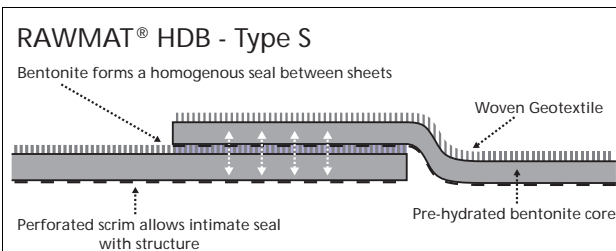

The vertical membrane shall be fixed using Rawmat Soft Washer fixings applied 500mm apart and 100mm below the top edge of the sheet. Alternatively, the membrane can be fixed using Rawtite Rapid Bond adhesive at an application rate of one "pea sized" drop onto the face of the membrane every 500mm.

Plant or equipment must be prevented from traveling on the RAWMAT<sup>®</sup> HDB Type S2 until the approved protection layer has been installed.



For applications where an immediate seal against hydrocarbons, contaminants or gases is required a liberal application of RAWPASTE Mastic must be made to the woven geotextile prior to lapping. RAWMAT<sup>®</sup> HDB Type S2 does not require further hydration to form an effective barrier against these contaminants.

Any necessary penetrations through the RAWMAT<sup>®</sup> HDB Type S2 shall be sealed by the application of RAWSEAL<sup>®</sup> TR35 and RAWPASTE Mastic, which is to be carried out in accordance with the manufacturer's instructions.

In the event of damage occurring to the RAWMAT<sup>®</sup> HDB Type S2 the damaged area shall be cleaned and overlain by a patch of the RAWMAT<sup>®</sup> HDB Type S2 at least 150mm larger in all directions than the damaged area. This should be secured using RAWPASTE Mastic or RAWMAT<sup>®</sup> Soft Washer fixings (on vertical application only).

At the end of each working day any exposed leading edges of the RAWMAT<sup>®</sup> HDB Type S2 shall be protected by wrapping in polythene and secured to prevent displacement. When placing blinding or backfill, care shall be taken to ensure that the overlaps are not disturbed or displaced. The protection shall be placed in the direction of the overlaps and not against the flow of the joints.

**For details of Rawell products and services visit [www.rawell.com](http://www.rawell.com)** where you can find more information suited to your specific needs, or call +44 (0) 151 632 5771

## Type S2

Application of Type S2 to horizontal blinded concrete surfaces

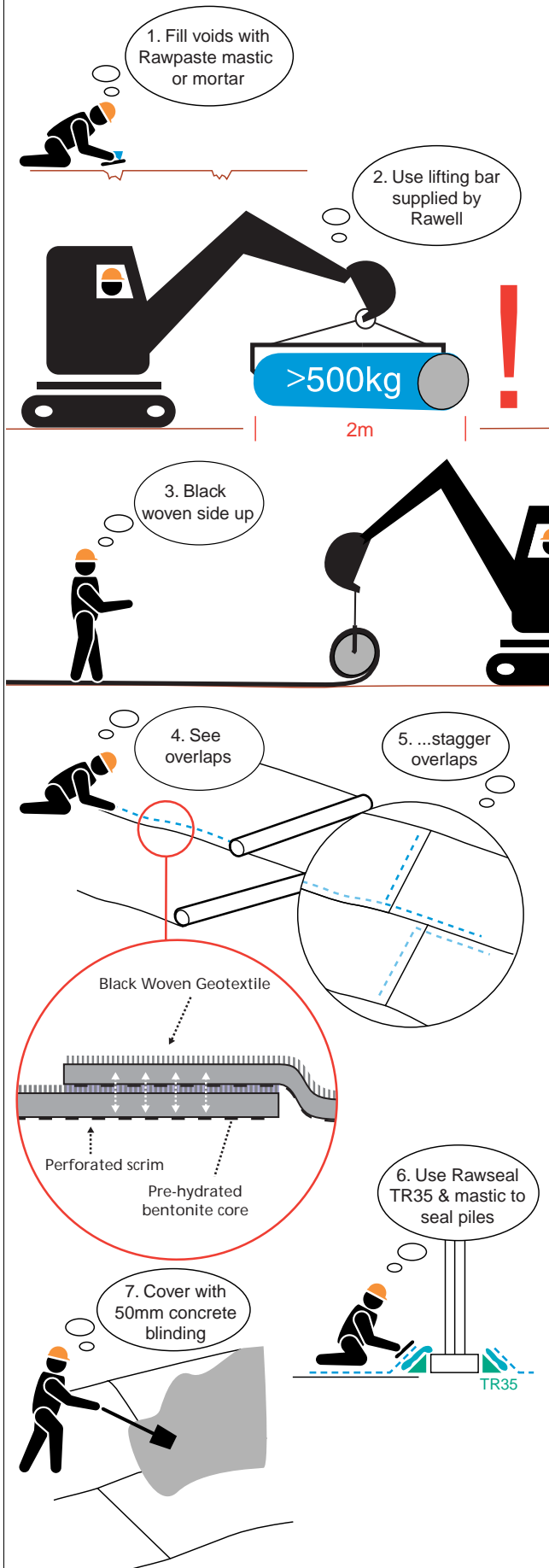

## ADVANTAGES OF RAWMAT® HDB

- ✓ 2m x 30m rolls reduce laps and speed up installation
- ✓ No extended curing or primers required - lays onto wet surfaces
- ✓ Simple to install no need for specialist labour
- ✓ Forms self sealing laps – no additional bentonite or taping joints
- ✓ “Active” system - bentonite self heals minor structural movement
- ✓ Tough geotextile carriers – no need for protection boards
- ✓ Natural clay base – will out live structure to which it's applied
- ✓ Immediate gas & vapour barrier
- ✓ No tracking of liquid between membrane and structure
- ✓ No further on site hydration required
- ✓ Unique environmentally friendly product - no solvents or VOC's
- ✓ Highly resistant to chemical degradation

## DESPATCH QUANTITIES

1 Roll = 2m x 30m = 60 m<sup>2</sup> - Average Weight = 510 kg  
 Approximate Roll Dimensions = 500mm Diameter x 2,010mm Width

45 Rolls (2,700m<sup>2</sup>) capacity per 40 ft Road Trailer/Container  
 45 Rolls (2,700m<sup>2</sup>) capacity per 40 ft Container

\* weight restrictions may vary from country to country due to legislation. Please obtain confirmation from Rawell on territorial transport legislation.

## HANDLING & STORAGE

RAWMAT® HDB Type S2 is rolled on 225mm diameter cores. Each roll is sealed in airtight polythene. The rolls are packaged on end into boxes, each box containing 45 rolls. The boxes are sealed with polythene box covers to weatherproof the box. Each box has a unique batch identification code. The RAWMAT® HDB Type S2 shall be stored and handled strictly in accordance with the manufacturers instructions, given below.

The storage area shall be dry and stable. Any RAWMAT® HDB Type S2 damaged during the delivery, storage or handling shall be rejected and shall not be incorporated in the works. Rolls may be stacked up to 3 high in their unopened state. Rolls must be stored under cover or protected with weatherproof sheets to prevent rain damage and drying out. Any part used roll can be re-wrapped and can be re-used if it has been protected in plastic to prevent moisture loss or saturation from rainfall.

All information contained within this document is given in good faith and is correct to the best of Rawell Environmental Ltd.'s knowledge. This information is not legally binding and may be changed at any time without notice.

Rawell Environmental Ltd, Carr Lane, Hoylake, Wirral, Merseyside CH47 4AZ.  
 Tel. +44 (0) 151 632 5771 Fax. +44 (0) 151 632 0252  
 www.rawell.com E-mail. postmaster@rawell.com